

Sanialarm



Occasional power outages, scaling of poorly maintained old appliances or even problems with clogged pipes, are all factors in significant variation of the water level permanently contained in SANITOILET or pump. To tackle this kind of unpredictability, SFA offers an efficient solution that provides instant alerts to avoid inappropriate use and take immediate action.

Product	EAN	Factory code	Compatible with
Sanialarm	3308810042799	-	Saniflo Sanitop Sanipro XR Sanipack Sanigrind Pro Sanibest Pro Sanivite Sanispeed

How does it work?

The Sanialarm attaches to the cover of the SFA device. It consists of a level pressure switch which automatically activates the warning buzzer when the water volume exceeds the maximum permitted level. The alarm then produces an intermittent sound until it is silenced and the problem resolved.

Easily install the Sanialarm



1 Insert 2 standard 1.5V batteries (not supplied) into the unit.

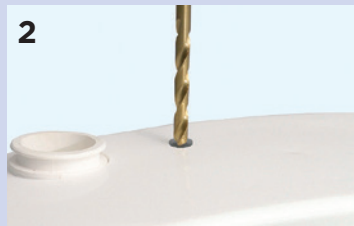

2 Drill a 10 mm diameter hole in the location shown on the appliance hood.



3 Coat with silicone grease before inserting the pressure switch tube of the Sanialarm.



4 Attach the Sanialarm inside the opening of the tube.



5 Switch to the ON position.

**BEFORE HANDLING:
DISCONNECT
THE POWER SUPPLY
FROM THE
SANITOILET**